



SK708

**150W DC/DC CONVERTER
MODULE WITH 9V TO 36V
INPUT / 12V OUTPUT,
EXTENDED TEMP. -40 TO 85°C**



MAIN FEATURES

- Wide Input Range: 9V to 36V DC
- 12V DC Output up to 12 Amp
- Over voltage protection
- Over current protection
- Surge protection
- Compact size
- Efficiency: Min. 91%
- Extended Temperature -40°C to 85 °C
(9V workable with derating 130W)

Specifications

► Specifications

| | |
|----------------------------|--|
| Input Voltage | 9V to 36V |
| Output | 150W, 12V @ 12 A |
| Performance Characteristic | Ripple: <300mV Line Regulation: <100 mV Load Regulation: <100 mV Efficiency: Min. 91% |
| Operation Temperature | -40 to 85°C |
| Dimension | 90(L) x 42(W) mm |

► Input/Output Connector

Voltage Input

| | |
|------------|------------|
| Pin Number | Assignment |
| + | 9V to 36V |
| GND | GND |

Voltage Output

| | |
|------------|------------|
| Pin Number | Assignment |
| + | 12V |
| GND | GND |

► Dimension

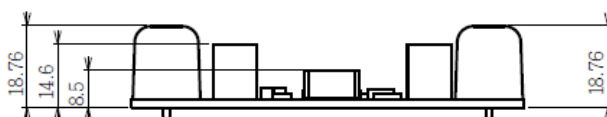
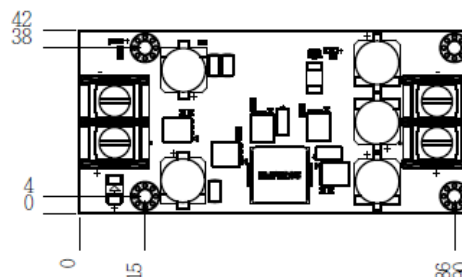

► Ordering Information

Modules

| Model Number | Description |
|--------------|---|
| SK708 | 150W DC/DC Converter Module with 9V to 36V Input 12V Output (-40 to 85°C) |

► Terminal Block

