

EMO L

Microgrid Controller

Perfectron SCH3X1



Specifications

Perfectron SCH3X1

SYSTEM

CPU	Intel Core i7-9700TE
Memory type	32 GB DDR4-2666MHz
Expansion Slot	2 x I/O Expansion Slots (Default: 4 x POE + 4 x COM) 2 x PCIe 3.X8
Storage Device	128 GB SSD 2 X 2.5" Easy swap SSD Tray
Others	TPM, FTDI support

REAR I/O

Power Input	DC 9V~48V
USB	4 x USB3.1, 2 x USB2.0
Ethernet	2 x RJ45 LAN
DisplayPort	1 x 20Pin DisplayPort connector (Female), up to 4096x2160@60Hz
DVI	1 x 20Pin DVI-I connector, 2560x1600@60Hz
COM	2 x RS232 / 422 / 485 (Support Power 5V / 12V)
PS/2	1
Audio	1 x Mic-in, 1 x Line-out
Graphic External Power	1 x 12V
Terminal Block	1 x 2Pin Terminal Block Remote Power ON/OFF 1 x 2Pin Terminal Block Remote Reset 1 x 4Pin Terminal Block External FAN Connector 1 x 3Pin Terminal Block Power Input

FRONT I/O

Power Button	1 with LED indicator
HDMI	1 x 19Pin HDMI1.4 connector, up to 3840x2160@30Hz
USB	2 x USB 3.0
Serial Port	2 x COM (RS232 / 422 / 485)
POE	4 x RJ45

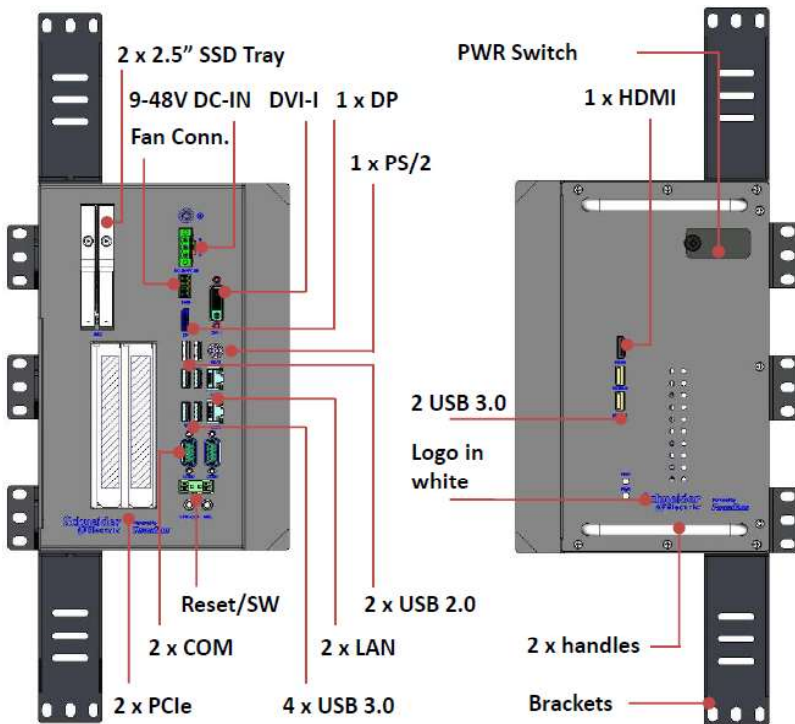

System

Intel Core i7-9700TE
 32 GB DDR4-2666MHz
 128 GB SSD
 2 X 2.5" Easy swap SSD Tray
 TPM, FTDI support

Interfaces

6 x USB 3.0, 2 x USB2.0
 1 x DP, 1 x DVI, 1 x HDMI
 2 x COM (RS232 / 422 / 485)

Mechanical Dimensions

Perfectron SCH3X1

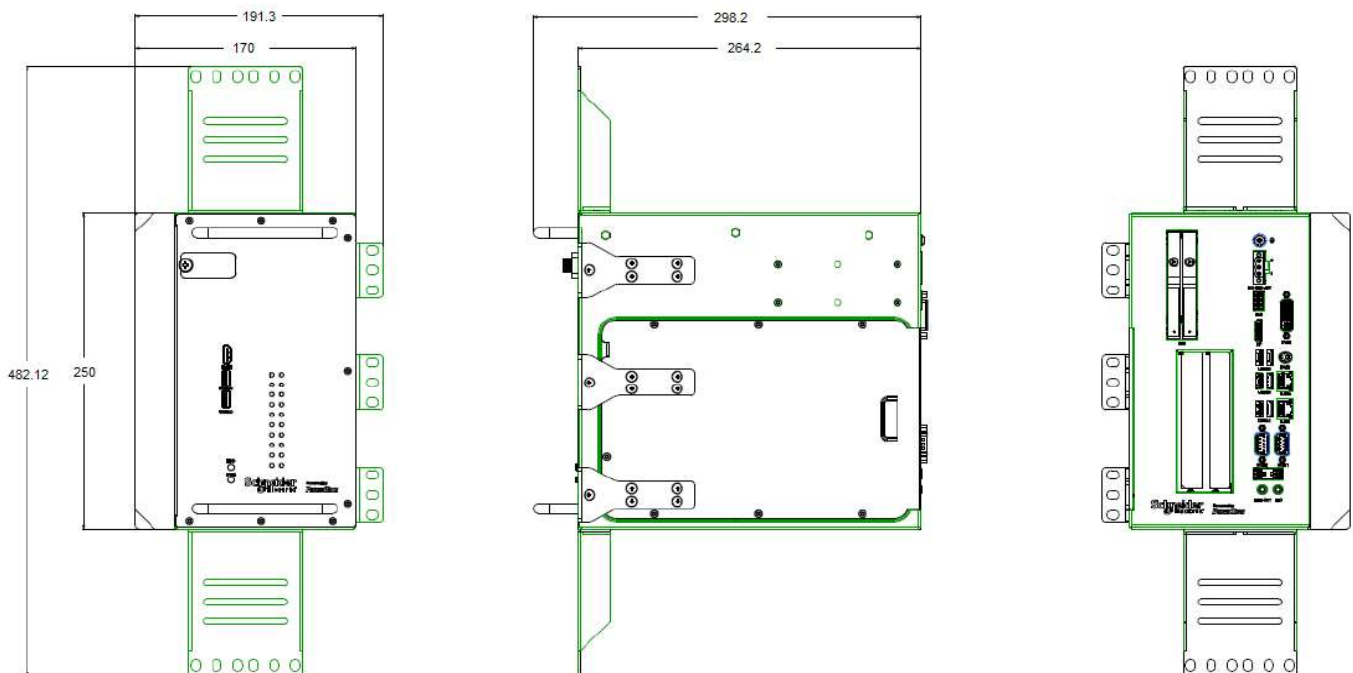

Mechanical and Environmental Specifications

Dimension	170 x 264 x 250 mm (W x D x H)
System Design	Fanless
Mounting	Rackmount Cube
Operating Temp.	-40 °C to 60 °C (35W CPU)
Storage Temp.	-40 °C to 85 °C
Relative Humidity	5% to 95%, non-condensing