



VC3905

GMSL Camera® 2MP GMSL2 Camera

Indie GW5200 5th-gen eWARP® geometric processor



Feature

- Output format: Uncompressed YUV422 format
- S-mount IP67 compliant lens focused
- Multi-Camera synchronization Support
- Support different focal length lens
- FCC , CE and RoHS
- Extreme Temperature Support -40~+85 degree

Introduction

The VC390S camera is equipped with SONY CMOS image sensor IMX390 and Maxim GMSL2. It has an automotive-grade sensor with a well-tuned Image Signal Processor (ISP) that produces exceptional image quality, which comes with an IP67-rated enclosure – is supplied with an M12 lens that is focused and glued in our factory.

VC390S are built to operate in harsh environmental conditions, the operating temperatures as low as -40°C to as hot as 85°C.

Specifications

ISP – Image Signal Processor	Indie GW5200 5th-gen eWARP® geometric processor Supports up to 2MP image sensors
IMAGE SENSOR	SONY 2.12MP IMX390 RGGB
MAX Resolution	1920*1080
Frame Rate	@30fps
Pixel Size	3.0um
Serializer	MAXIM MAX9295A
Output Image Format	YUV422 8bit
Camera Interface	GMSL2, Up To 6Gbps
Power	9V~16V DC
Power consumption	< 1.8W
Connector	FAKRA Z code
Shutter Type	Rolling Shutter
Ingress Protection	IP67
Dimension	W: 30mm, L:30mm, H:32mm
Operating Temp	-40 to 85°C
Storage Temp	-40 to 85°C
Relative Humidity	15% to 95%, non-condensing

Application

- Automotive
- ADAS + Viewing Fusion
- High Dynamic Range Imaging
- Autonomous Driving
- Robots

Block Diagramation

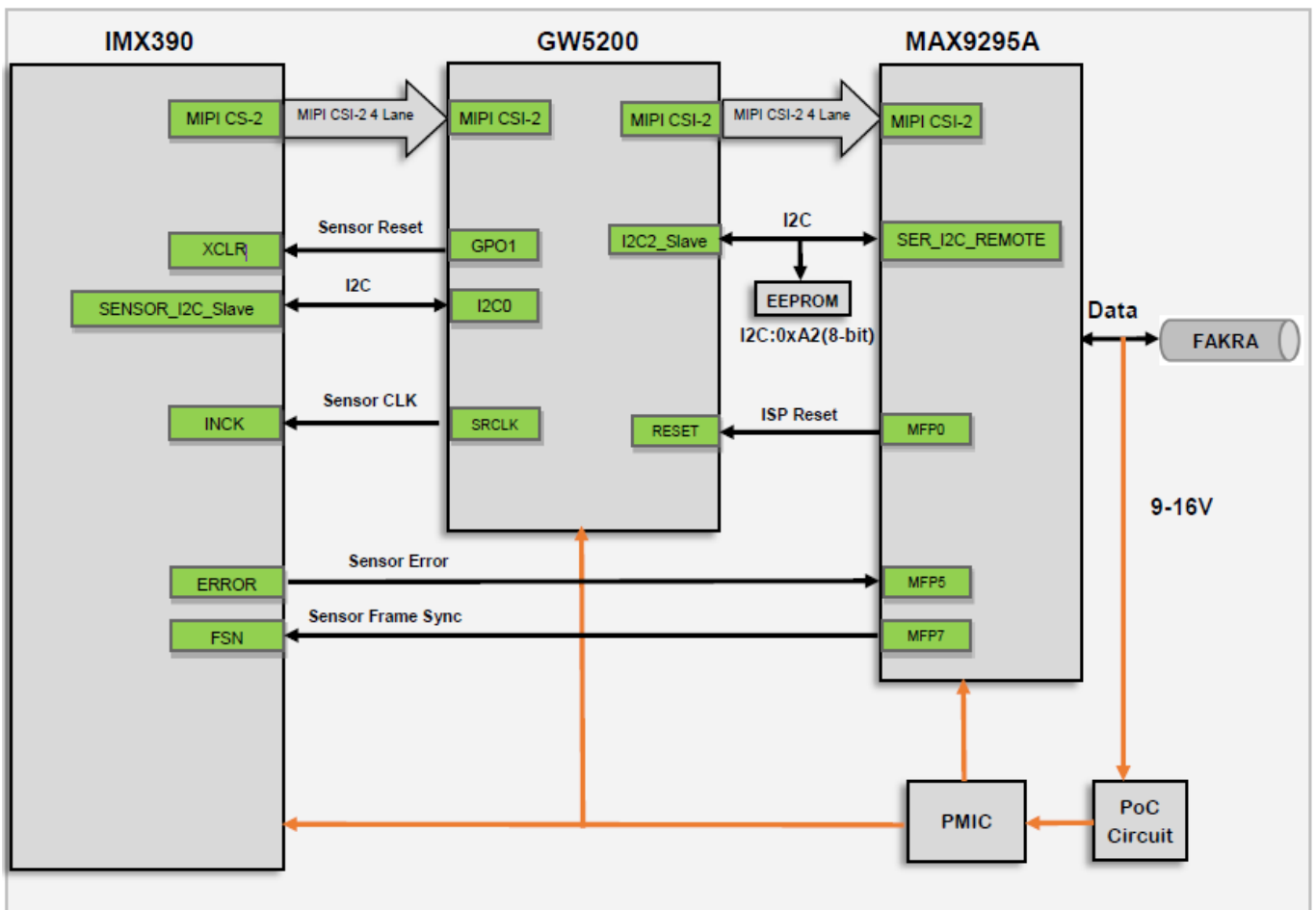

Ordering Information

Model	HFOV	VFOV	F.No.	EFL	Max. Optical Distortion	Water Proof	Lens Mount
VC390S-H30X	30°	17°	1.6	10.96mm	-2%	IP67	M12
VC390S-H60F	60°	32°	1.6	5.8mm	-21.5%	IP67	M12
VC390S-H100F1	100°	53°	1.6	3.55mm	-45%	IP67	M12
VC390S-H120H	118°	62°	2.0	3mm	-62%	IP67	M12
VC390S-H190X	196°	112°	2.0	1.51mm	-155%	IP67	M12

Appearance

VC390S-H30X:



VC390S-H120H:



Dimension

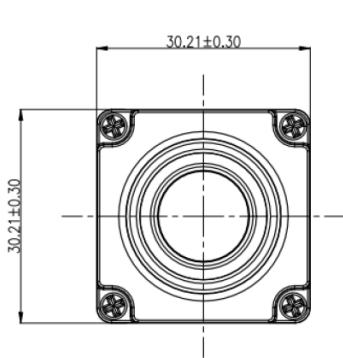

Front View

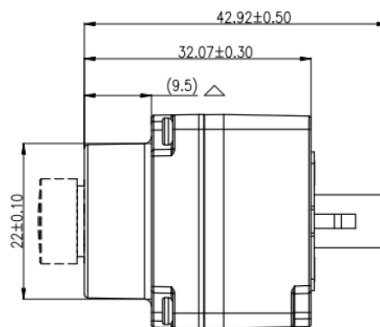

Side View

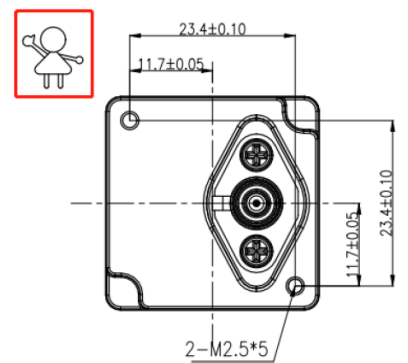

Rear View